



## Standard Features

- Aluminum frame, Cover and Type 304 Stainless Steel Fan Guards
- Built-In 0-100°F adjustable thermostat
- NEMA 5-15 Plug on 120VAC units
- Standard line cord for other voltages
- Environmentally Friendly - No CFC's, Oils or Gases
- No Maintenance
- Integral condensate drip pan (vertical mount only)
- Military Grade Hot-side fans (MG unit only)
- 12 month warranty
- Made in the USA

## Included

- Installation and Operation Manual
- Mounting gasket
- Stainless Steel Mounting Hardware

## Standard Voltages

- 120VAC 50/60 Hz
- 240VAC 50/60 Hz
- 24/28VDC

Model #	Available Voltage	Input Voltage Range	Current	Heating Capability	Mounting Flange Dimensions	Certification	Weight	Mounting
AAC-145-4XT-E-M34	120VAC	95-130VAC	6.3 A	N/A	12.625" H X 19.526" W	ETL to UL 1995	42 LBS.	N/A
	240VAC	190-260VAC	4.6 A					
AAC-145-4XT-E-HC-M34	120VAC	95-130VAC	6.3 A	400 WATTS	12.625" H X 19.526" W	ETL to UL 1995	42 LBS.	N/A
	240VAC	190-260VAC	4.6 A					
AAC-145-4XT-E-M34/04	24VDC	23 - 26 V	19 A @24VDC	N/A	12.625" H X 19.526" W	N/A	42 LBS.	N/A
AAC-145-4XT-E-HC-M34/04	24VDC	23 - 26 V	19 A @24VDC	400 WATTS	12.625" H X 19.526" W	N/A	42 LBS.	N/A
AAC-145-4XT-E-M34/105	120VAC	95-130VAC	6.3 A @ 120VAC	N/A	12.625" H X 19.526" W	N/A	42 LBS.	N/A
	240VAC	190-260VAC	4.6 A @ 240VAC					
AAC-145-4XT-E-HC-M34/105	120VAC	95-130VAC	6.3 A @ 120VAC	400 WATTS	12.625" H X 19.526" W	N/A	42 LBS.	N/A
	240VAC	190-260VAC	4.6 A @ 240VAC					
AAC-145-4XT-E-MG	28VDC	26-28VDC	19 A @24VDC	N/A	12.625" H X 19.526" W	N/A	42 LBS.	N/A
	120/240VAC	95 - 130VAC	6.3 A @ 120VAC					
	120/240VAC	190 - 260VAC	4.6 A @ 240VAC					
AAC-145-4XT-E-HC-MG	28VDC	26-28VDC	19 A @24VDC	400 WATTS	12.625" H X 19.526" W	N/A	42 LBS.	N/A
	120/240VAC	95 - 130VAC	6.3 A @ 120VAC					
	120/240VAC	190 - 260VAC	4.6 A @ 240VAC					

# 1500 BTU - 145-M34 AND MILITARY GRADE (MG) SERIES

## THERMOELECTRIC AIR CONDITIONER

<b>NEMA Rating:</b>	4X
<b>Cooling T-Stat set range:</b>	0-100°F
<b>T-Stat Accuracy:</b>	±2°F
<b>T-Stat Hysteresis:</b>	5F
<b>Heating T-stat set point:</b>	ON @ 45F, OFF @ 55F
<b>Cold-side airflow:</b>	230 cfm
<b>Hot-side airflow:</b>	260 cfm
<b>Operating temperature:</b>	-4 to 140 °F
<b>Storage temperature:</b>	-4 to 194 °F
<b>Warranty:</b>	12 months

### Optional Equipment

- Condensate Drip Pan
- Extension Frame
- Rain Shroud
- Digital Temperature Controller
- Black Epoxy Coating
- Recessed Frame
- Extended Warranty

### Customizations

- Stainless Steel Construction for Extreme Environments
- Custom color finish
- Increased heating capability
- 48VDC power configuration
- Non-standard Mounting configurations
- And More - Please inquire for details*

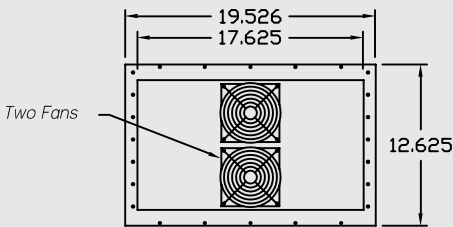
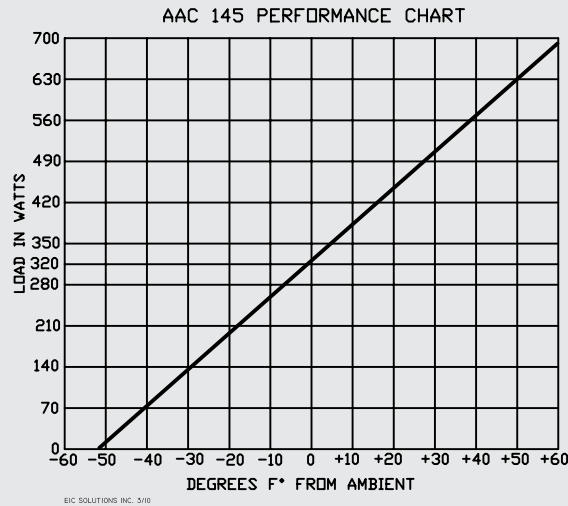

**Hot Side**  
(External to Transit Case)

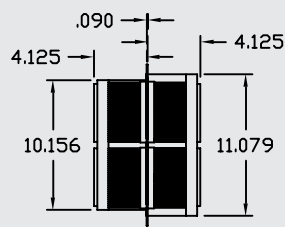

**End View**

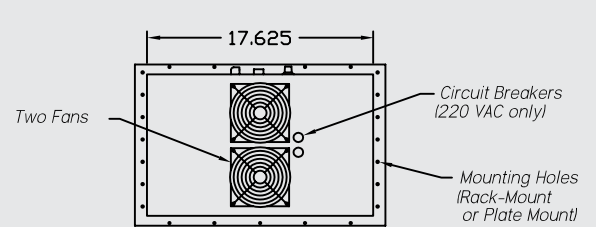

**Cold Side**  
(Internal to Transit Case)